

# 2023 MUNICIPAL PARKING LOT IMPROVEMENTS

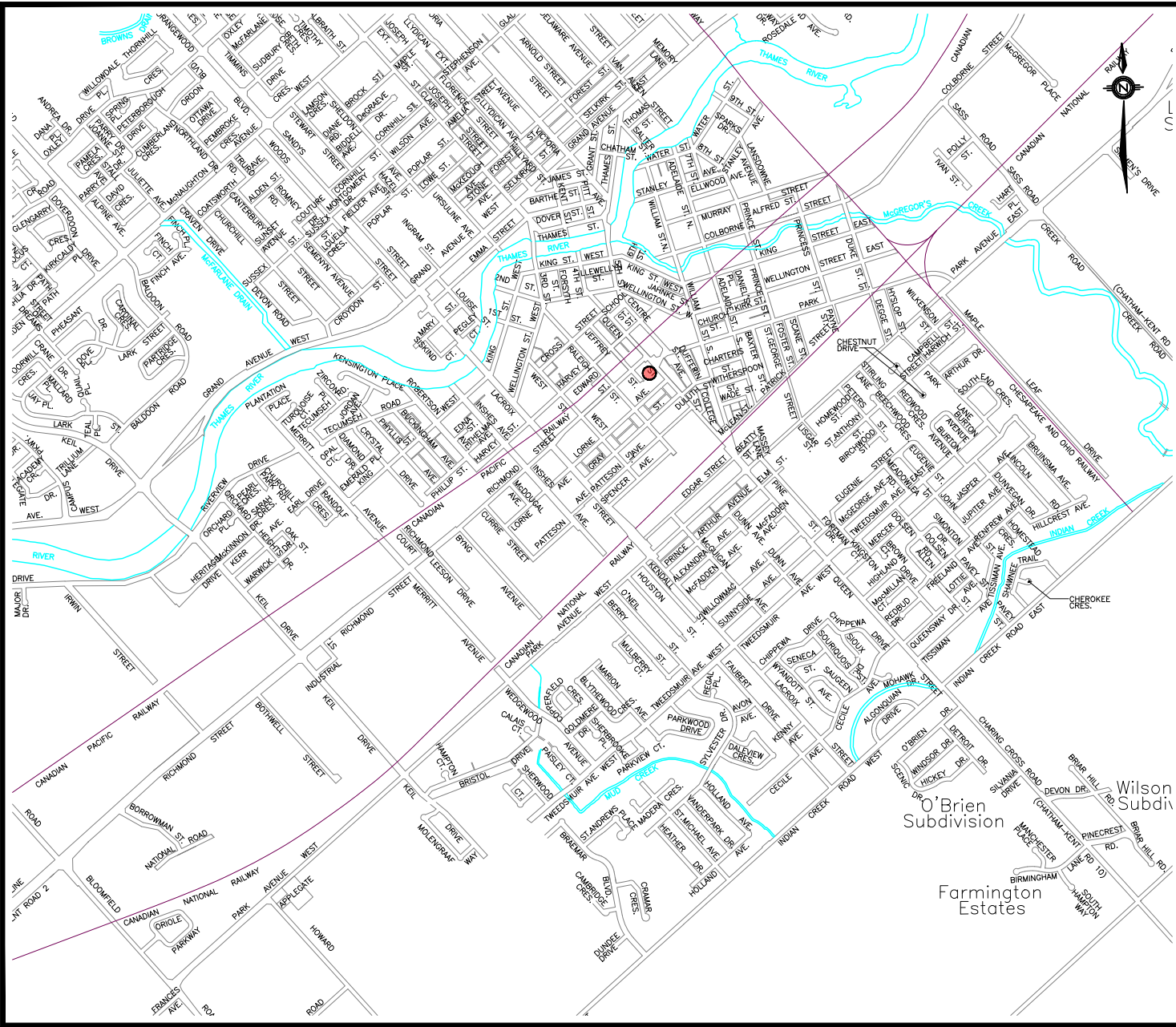

CHATHAM MUNICIPAL LOT 8



  
 Cultivating Growth. Shore to Shore
   
**MUNICIPALITY OF CHATHAM-KENT**
  
*Infrastructure & Engineering Services*
  
*Engineering & Transportation Division*

## APPENDIX A MUNICIPAL PARKING LOT IMPROVEMENTS LOCATIONS

SHEET NO.  
1 OF 4

**2023 MUNICIPAL PARKING LOT IMPROVEMENTS**



**BLENHHEIM ARENA**

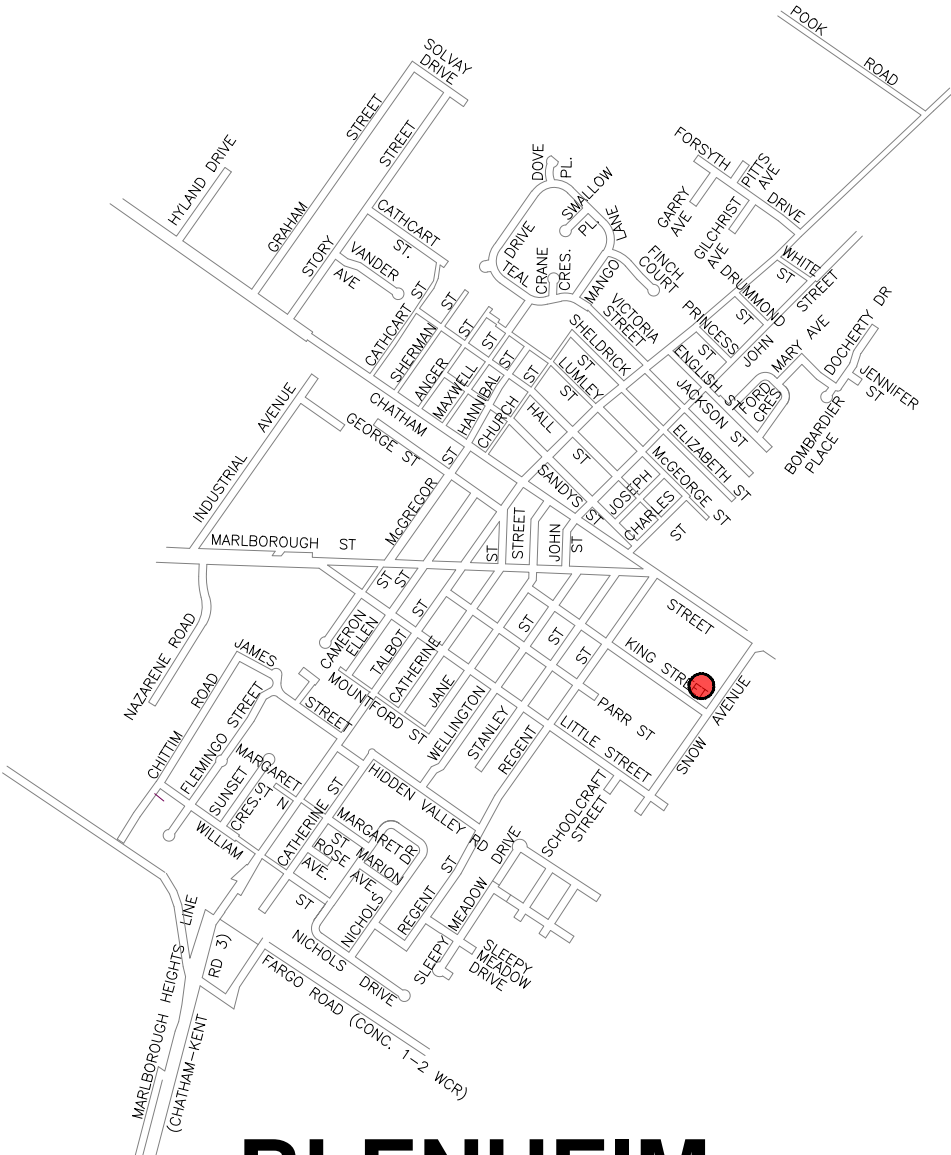

**BLENHHEIM**



MUNICIPALITY OF CHATHAM-KENT  
*Infrastructure & Engineering Services*  
*Engineering & Transportation Division*

**APPENDIX A  
 MUNICIPAL PARKING LOT  
 IMPROVEMENTS LOCATIONS**

SHEET NO.  
 2 OF 4

**2023 MUNICIPAL PARKING LOT IMPROVEMENTS**

- WALLACEBURG MUNICIPAL LOT K
- WALLACEBURG MUNICIPAL LOT H

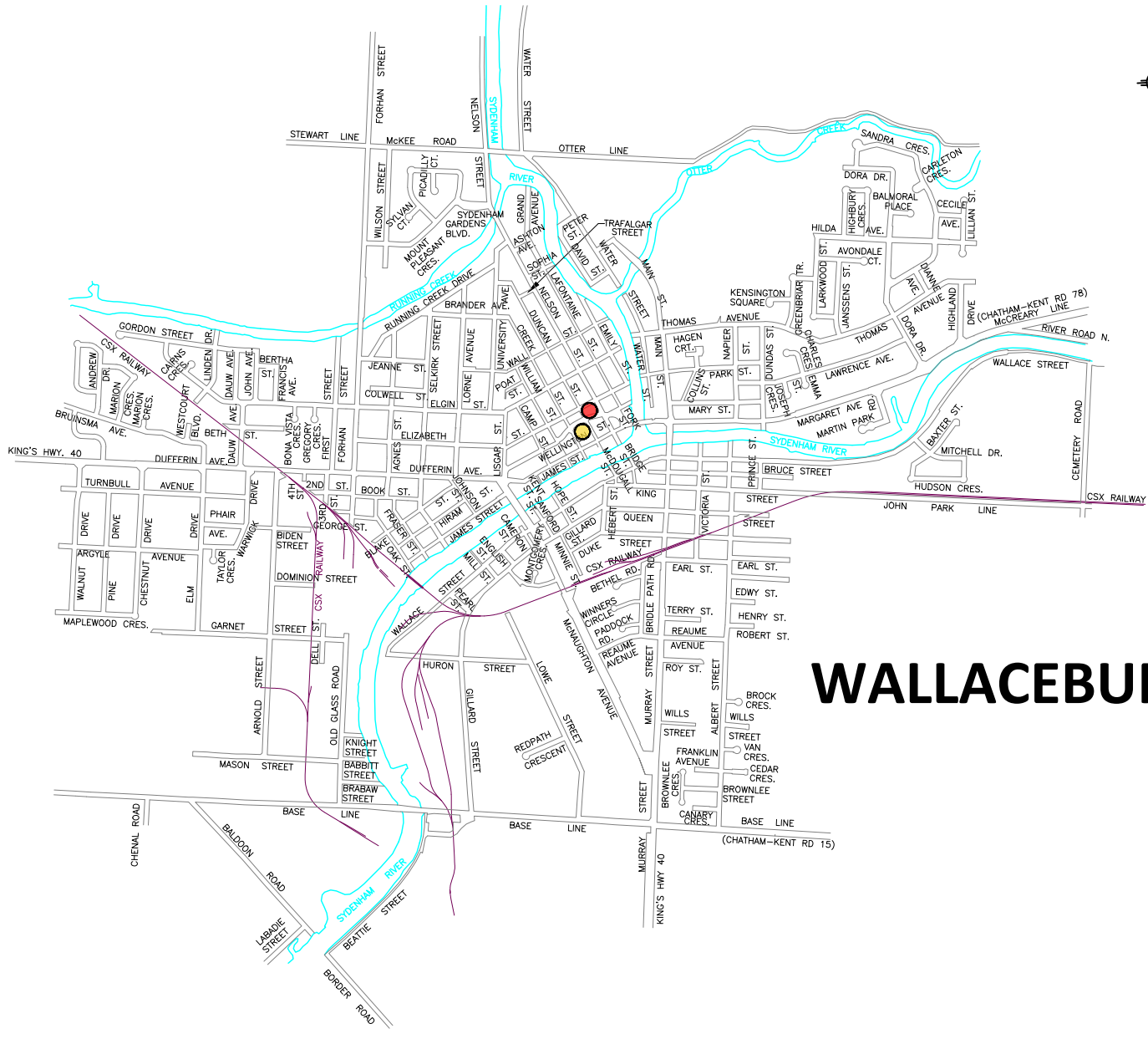

**WALLACEBURG**



**MUNICIPALITY OF CHATHAM-KENT**  
*Infrastructure & Engineering Services*  
*Engineering & Transportation Division*

<b>APPENDIX A</b>	<b>SHEET NO.</b>
<b>MUNICIPAL PARKING LOT IMPROVEMENTS LOCATIONS</b>	<b>3 OF 4</b>

# 2023 MUNICIPAL PARKING LOT IMPROVEMENTS



CHATHAM TOWNSHIP PUBLIC WORK'S YARD



MUNICIPALITY OF CHATHAM-KENT  
*Infrastructure & Engineering Services*  
*Engineering & Transportation Division*

**APPENDIX A**  
**MUNICIPAL PARKING LOT**  
**IMPROVEMENTS LOCATIONS**

SHEET NO.  
4 OF 4